

W&T

www.WuT.de

Instruction

Mounting and wiring

RS485 Schraubschnurzel

#11909

Release 03/2024

Content

1. Legal information	3
Warning concept	3
Qualified personnel	4
Disposal.....	4
Symbols on the product	4
2. Safety instructions	5
General information	5
Intended use.....	5
Electrical safety.....	5
3. Product description	7
RS485 Schraubschnurzel.....	7
Pinout.....	7
Compatibility.....	8
4. DIL switch settings	8
Termination	9
5. Connection example	10
Assembly.....	10
6. Product dimensions	11
7. Technical data	12

1. Legal information

As we can make mistakes, none of our statements may be used without verification. Please notify us of any errors or misunderstandings you become aware of so that we can recognise and correct them as quickly as possible.

Warning concept

These instructions contain information that must be observed for your personal safety and to prevent damage to property. The instructions are emphasised by a warning triangle. Depending on the hazard level, the warnings are shown in descending order as follows:

Danger

Indicates a hazard that will result in death or serious injury if appropriate precautions are not taken.

WARNING

Indicates a hazard that could result in death or serious injury if appropriate precautions are not taken.

CAUTION

Indicates a hazard that could result in minor injury if appropriate precautions are not taken.

ATTENTION

Indicates a hazard that can result in property damage if appropriate precautions are not taken. If there are several hazard levels, the warning of the highest level is always used. If a warning notice with a warning triangle warns of personal injury, a warning of property damage may also be included in the same warning notice.



Qualified personnel

The product described in these instructions may only be installed and commissioned by personnel who are qualified for the respective task. The relevant documentation for the respective task must be observed, in particular the safety instructions and warnings contained therein. Qualified personnel are able to recognise risks and avoid potential hazards when handling the described products due to their training and experience.

Disposal

Electronic devices must not be disposed of with household waste, but must be disposed of properly as electronic waste.

Symbols on the product

Symbol	Explanation
	CE labelling The product complies with the requirements of the applicable the EU directives.
	UKCA labelling The product complies with the requirements of the applicable the guidelines of the United Kingdom (GB)
	WEEE labelling The product must not be disposed of with household waste, but must be in accordance with the disposal regulations applicable at the regulations for electronic waste.

2. Safety instructions

General instructions

These instructions are intended for the installer of the RS485 Schraubschnurzel described in the manual and must be read and understood before starting work. The devices may only be installed and commissioned by qualified personnel.

Intended user

DANGER

The RS485 Schraubschnurzel sold by Wiesemann & Theis is an adapter that is used to extend the RS485 interface on W&T devices. Any other use or modification of the adapter is not intended.

Electrical safety

DANGER

Before starting any work with the Schraubschnurzel, the power supply must be completely disconnected using suitable measures. Ensure that the device cannot be switched on again accidentally! The Schraubschnurzel may only be used in closed and dry rooms. The adapter should not be exposed to high ambient temperatures or direct sunlight and should not be operated in the vicinity of heat sources. Please note the restrictions with regard to the maximum ambient temperature. A distance of 10-15 cm should be maintained between the adapter and neighbouring heat sources.

Ensure that no individual wires are protruding from strands, that the complete strand is in the terminal and that the screws of the connection terminals are tight. Tighten the screws of unused terminals.

ATTENTION

The complete declarations of conformity for the devices described in the instructions can be found on the respective Internet data sheet page on the W&T homepage at <http://www.wut.de>.

3. Product description

RS485 Schraubschnurzel with 1x RS485 (DB9) & A-/B+/GND

RS485 DB9 socket to 3-pole screw contact for tapping, forwarding or distributing an RS485 signal.

Pinout

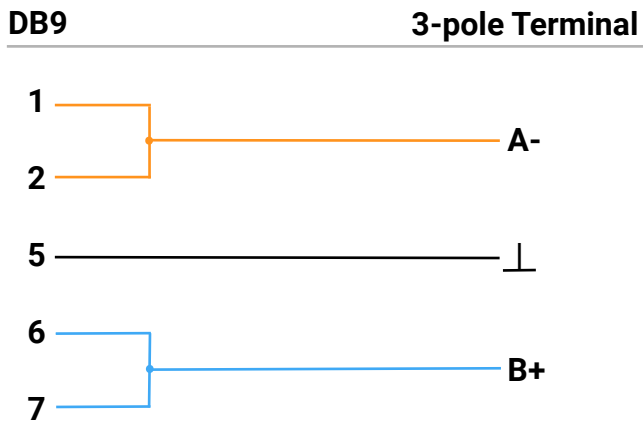

Compatibility

The RS485 Schraubschnurzel is compatible with the following RS485 capable W&T devices

Overview

Devices	Article number
Serial PC cards	#13631, #13610, #13611, #13601
Modules	#18611, #18613, #18813
Interfaces	#86201, #86203, #64201, #38211, #61201, #81215, #61210, #65210
COM-Server	#58665, #58662, #58661, #58651, #58652, #58034, #58669

4. DIL switch settings

To extend the RS485 2-wire signal, the DIL switches on the W&T interface must be set correctly. For details, see the instructions for your device.

All RS485 operating modes require the bus system to be terminated with a termination network, which ensures a defined idle state in the high-impedance phases of bus operation. The bus system can be connected to a termination network in the interfaces by closing DIL switches 6 and 7 on the RS422/RS485 module. A maximum of 2 terminations per segment are permitted.

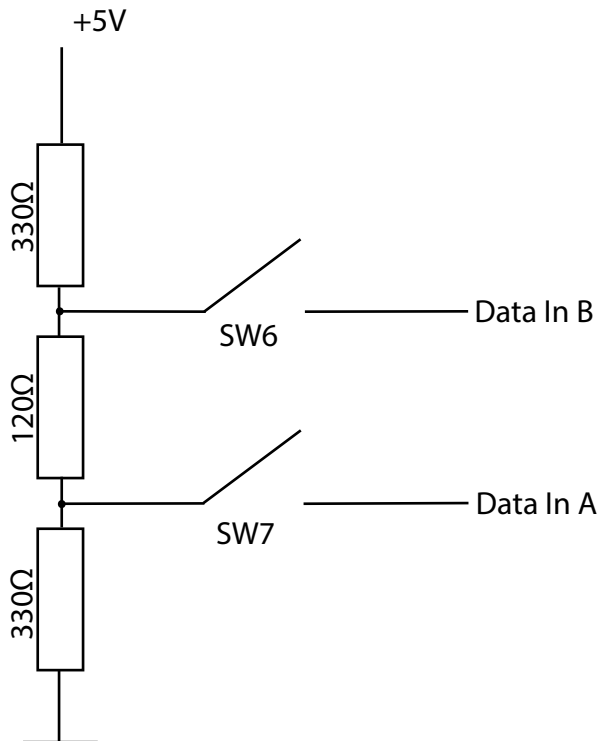

5. Connection example

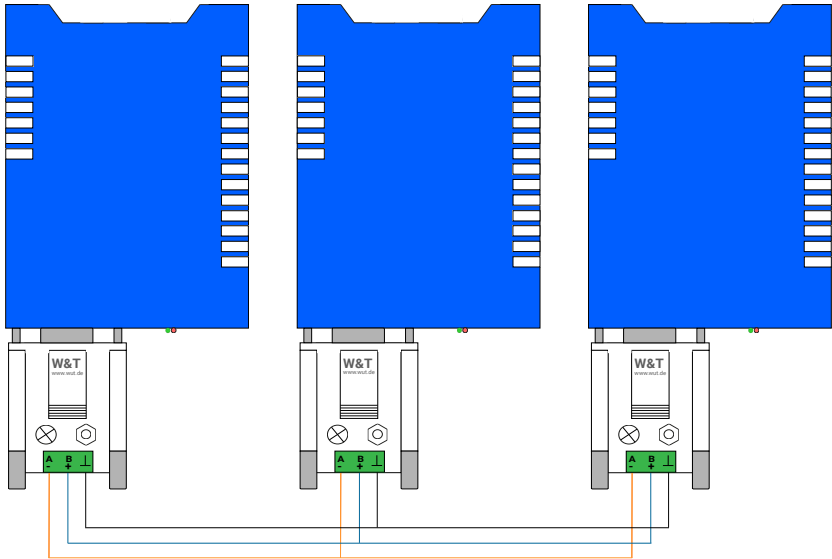

Mounting

The RS485 Schraubschnurzel is intended for mounting on a W&T RS485-capable interface. The adapter has two screws for mechanical fixing.

6. Product dimension

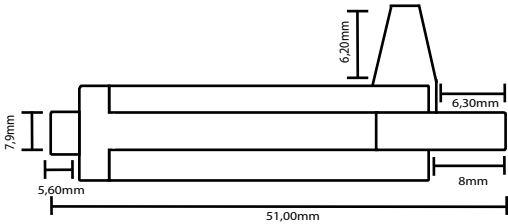
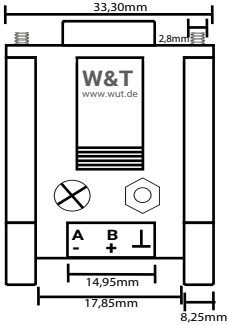

± 0,2mm

7. Technical data

Connections

Connection 1x DB9 RS485 2-wire socket
1x 3-pole screw contact (A-/B+/signal-ground)

Other data

Housing: Plastic
Protection class: IP20
Storage temperature: -25°C .. 70°C
Operating temperature: 0°C .. 70°C
Permissible humidity: 5..95% Relative humidity (non-condensing)



Wiesemann & Theis GmbH
Porschestraße 12
42279 Wuppertal / Germany

Mail info@wut.de
Web www.wut.de

Tel. +49 (0)202 2680-110
Fax +49 (0)202 2680-265